

The Positive Role of Socio - Spatial Research and Design in Creating Intercultural Respect and Social Sustainability in Contemporary Cities

Case of An Alternative Approach to Architectural Education and Practice



**Asiya Sadiq & Christophe Polak
Architects- Urban Planners - Researchers – Academics**

**Public Hearing on Intercultural Dialogue and Education for Mutual Understanding
European Parliament - Brussels – Tuesday - 15 September 2015**

Urban Profile Process

ECONOMICS

Production & Resourcing
Exchange & Transfer
Accounting & Regulation
Consumption & Use
Labour & Welfare
Technology & Infrastructure
Wealth & Distribution

ECOLOGY

Materials & Energy
Water & Air
Flora & Fauna
Habitat & Settlements
Built Form & Transport
Embedment & Sustenance
Emission & Waste

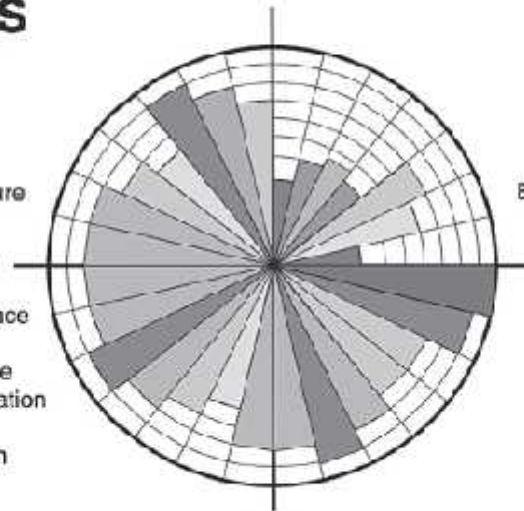

Organization & Governance
Law & Justice
Communication & Critique
Representation & Negotiation
Security & Accord
Dialogue & Reconciliation
Ethics & Accountability

POLITICS

Identity & Engagement
Creativity & Recreation
Memory & Projection
Belief & Meaning
Gender & Generations
Enquiry & Learning
Well-Being & Health

CULTURE

Circles of Sustainability

FIGURE 0.1 *Circles of Sustainability: Urban Profile Process*

Sustainable Cities and Communities Require;

Mutual Respect, Common Resources and a Collective Purpose, leading to a Harmonious, Balanced and Productive Society at Large

Source:

James, Paul; with Magee, Liam; Scerri, Andy; Steger, Manfred B. (2015). *Urban Sustainability in Theory and Practice: Circles of Sustainability*. London: Routledge.

CIRCLES of SOCIAL LIFE

and beyond

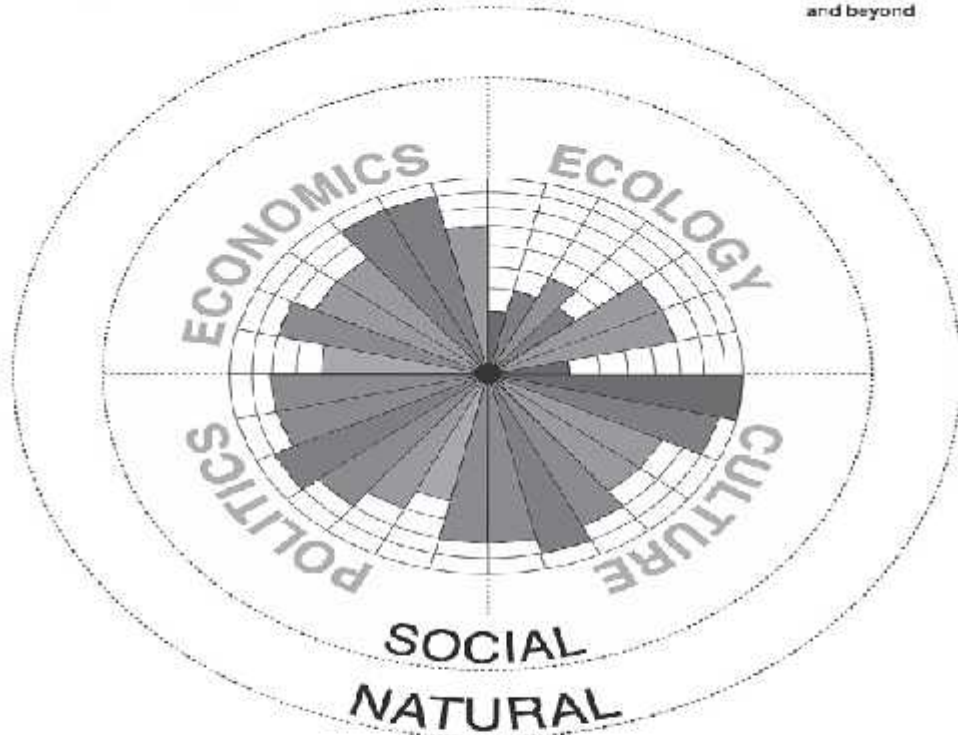

DOMAINS OF THE SOCIAL

ECONOMICS

Production & Resourcing
Exchange & Transfer
Accounting & Regulation
Consumption & Use
Labour & Welfare
Technology & Infrastructure
Wealth & Distribution

POLITICS

Organization & Governance
Law & Justice
Communication & Critique
Representation & Negotiation
Security & Accord
Dialogue & Reconciliation
Ethics & Accountability

ECOLOGY

Metabolism & Energy
Water & Air
Flora & Fauna
Habitat & Settlements
Built Form & Transport
Embodiment & Sustainance
Emission & Waste

CULTURE

Identity & Engagement
Creativity & Recreation
Memory & Projection
Belief & Meaning
Gender & Generations
Equity & Learning
Well-Being & Health



FIGURE 1.1 Circles of Social Life

New Thinking in Sustainability

Holds that

Social Sustainability

Encompasses and Holds Together

ecological, economic, political and
cultural sustainability

social sustainability encompasses

all human activities

and becomes

Critical to Life

Source:

James, Paul; with Magee, Liam; Scerri, Andy; Steger, Manfred B. (2015). *Urban Sustainability in Theory and Practice: Circles of Sustainability*. London: Routledge.

Sustainability

“a way”

“the way”

“the only way”

“For us, architecture is situated within a larger context and the city is a living organism. All architecture and design becomes formal via public engagement and an understanding of collective problem solving, finding innovative ways to reclaim and reimagining shared public space.”

(asiya sadig and christophe polak, TRT Catalogue, 2010 Statement)

MIGRATION FLOWS IN MEDITERRANEAN REGION



Current Refugee Crisis in EU
Continuation of a **Tradition**,
On the way of becoming a **Norm**

Non Response to social Sustainability
Results In
Critical Social-Spatial Issues Like;

- Social Alienation
- Divided City and Urban Angst
- Lack of Spaces for Positive Collective Expression and Action
- Informal Networks Developments and Harsh Political Responses
- Difficult Integration, especially of the Youth
- Communal Movements and Unregulated Growth
- Resultant Encroachments, Congestion, Pollution and Space Defiance

Lack of Interrelationships between; Reality, Research and Practice

- **Reality**

- Strong Research on migration, integration and social cohesion
- lack of comparative research, Integrating levels of analysis
- lack of cooperation between disciplines and professions
- lack of integration of the social data to space and city making .

- **Need for a new Mindset in Socio-Spatial Research**

- Rethinking the relation between migration and settlement s and public life and space
- Shifting the focus from migrants integration to overall society Regeneration (both formal and informal)
- Interdisciplinary policies, programmes and projects

- **Research and Practice Themes in Socio-spatial Integration**

- Defining citizenship: rights and political participation
- Assessing entrepreneurship and integration into City Making
- Change in Mindset ; Viewing Cultural, religious and linguistic diversity in Europe (or elsewhere)as an Asset
- Identity, representation, cultural integration and safeguarding specificities
- Time and Space , generations and gender in migration and settlement

Sustainability Myths and Reality

Dispelling the Myths	Promoting the Reality
Sustainability is about high resources	Sustainability is about resilience, innovation and sustenance
Sustainability is about high technology design	Sustainability is about high social design
Architectural Sustainability is about Building Designs	Architectural Sustainability is about Trans - Sectoral Design
Sustainability is about global agendas	Sustainability is about global but also equally about local realities
Sustainability is about laws, policies and regulations	Sustainability is about Thinking, Mind Set and World View

**How
can we do it ??????????????**

Case of An Alternative Approach to Architectural Education and Practice

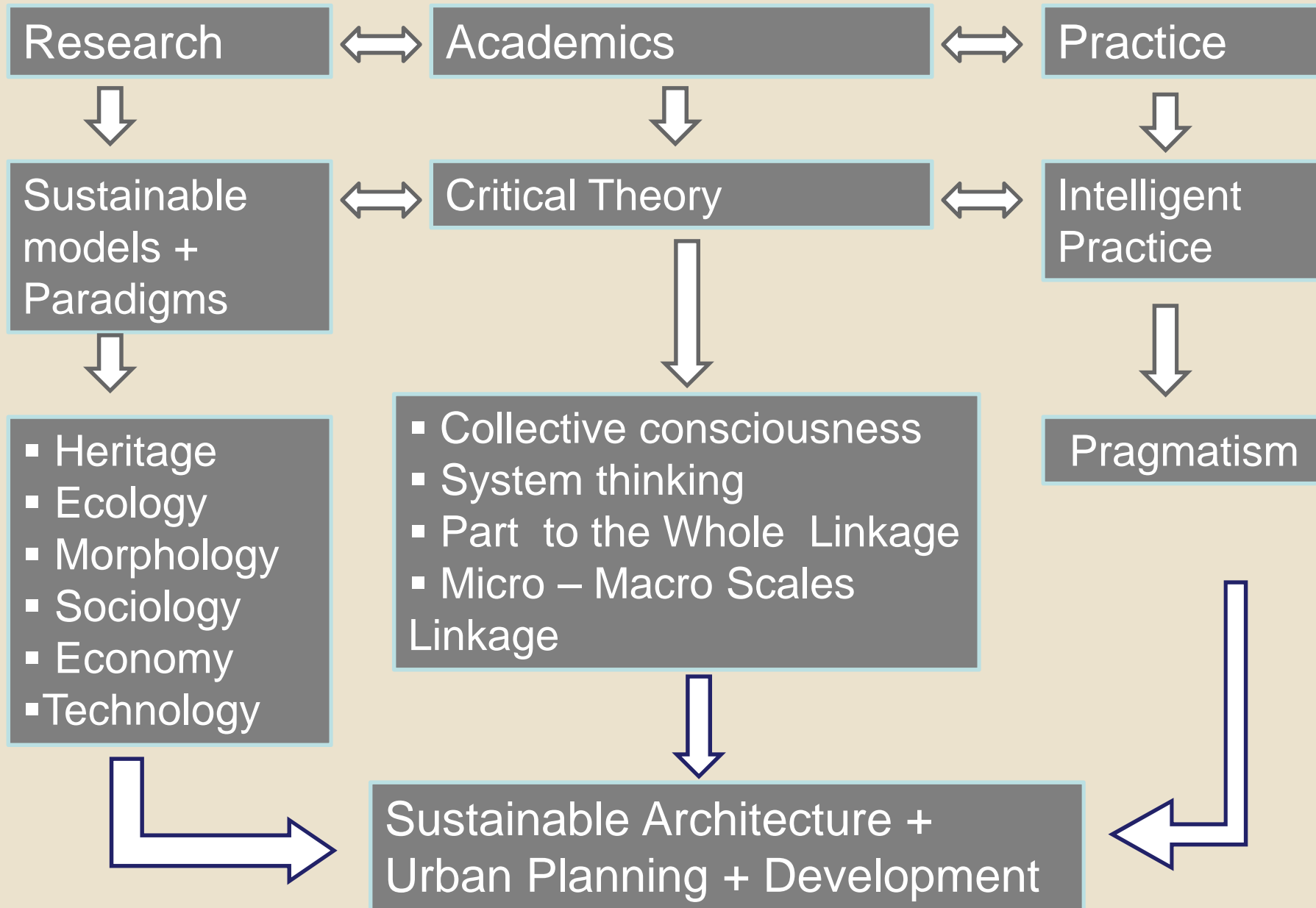

... start developing a reflective attitude!

in relation to society in general, the relationship of global and local environmental, social and economic issues to the built habitat, towards the architectural practice; towards the site, the design brief, specific challenges at hand...

... critically observe!

in a cross-scalar and cross-sectoral way what is already there in the physical world but also in the cultural, social and imaginary ... sphere.

... Debate

to get inspired, to find similarities and differences, to discover logics and strategies, to develop a sensibility...

... use a common language!

A common Language net creates a common mindset, empathy and actions

Perspective 01 : Supporting Cultural Consolidation at the Origin

Socio - Spatial Research and Design in Creating Intercultural Respect and Social Sustainability in Contemporary **Asian Cities**

EU funded “Asia Link” and Asia Urbs Programme 2004-2007

A collaborative project between 05 universities of Europe and South Asia under the auspices of European Commission funded Asia Link and Asia Urbs Programme.

The partners included; KU Leuven, University of Eindhoven, University of Moratowa - Sri Lanka and CEPT University, Ahmadabad, India and DAP-NED University.

The research focused on impacts of Mega projects on cities, feeding into curriculum development and faculty training.

The project has been successfully completed with 05 publications.

DEFINING CITIZENSHIP: RIGHTS AND POLITICAL PARTICIPATION



- Assessing entrepreneurship and integration into City Making
- Change in Mindset ; Viewing Cultural, religious and linguistic diversity in Europe (or elsewhere) as an Asset
- Identity, representation, cultural integration and safeguarding specificities
- Time and Space , generations and gender in migration and settlement

Polak Christophe (contribution), **"Karachi, SITE Town and the Orangi Nalla, Living and Working in the Riverbed: Six Micro-stories"**, Published by the European Union, 2007

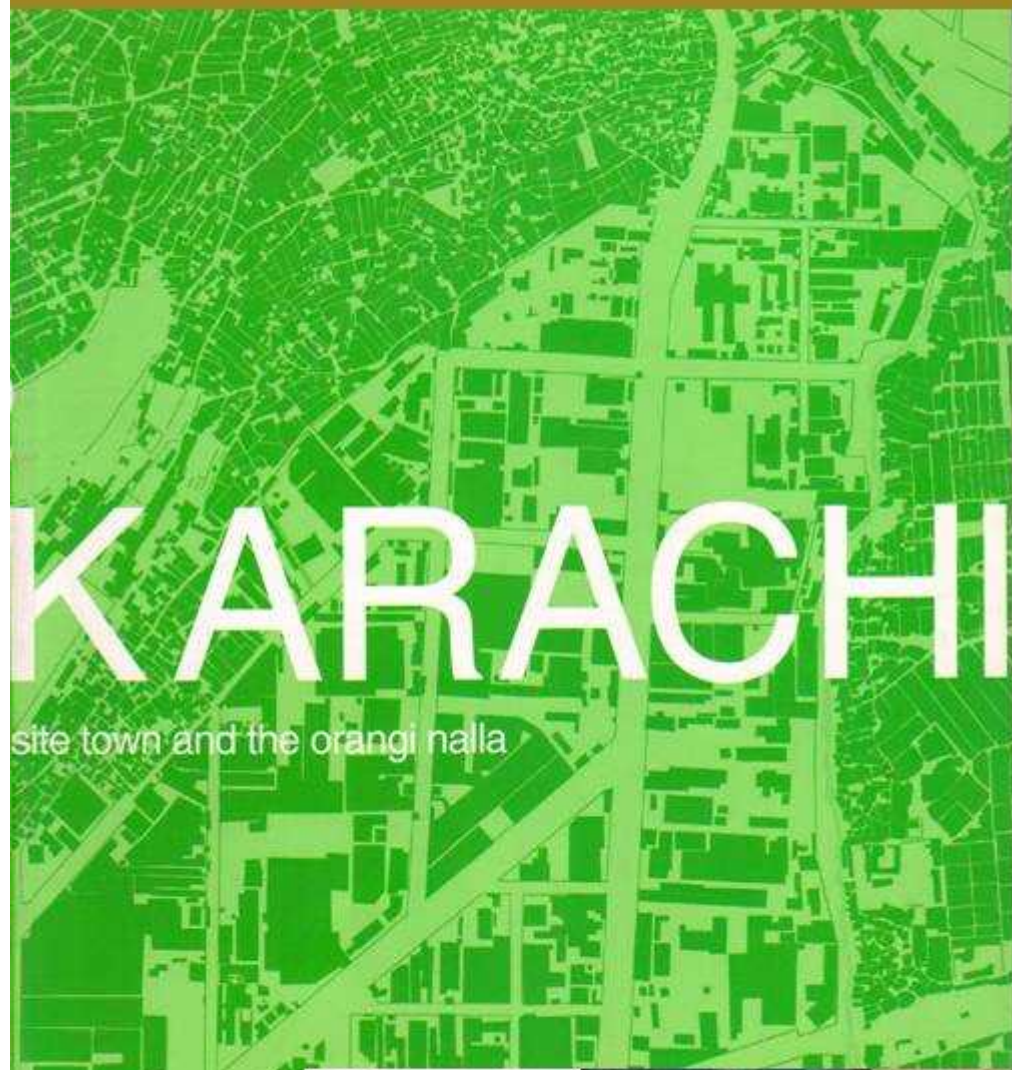



Lyari river bed a productive landscape ?



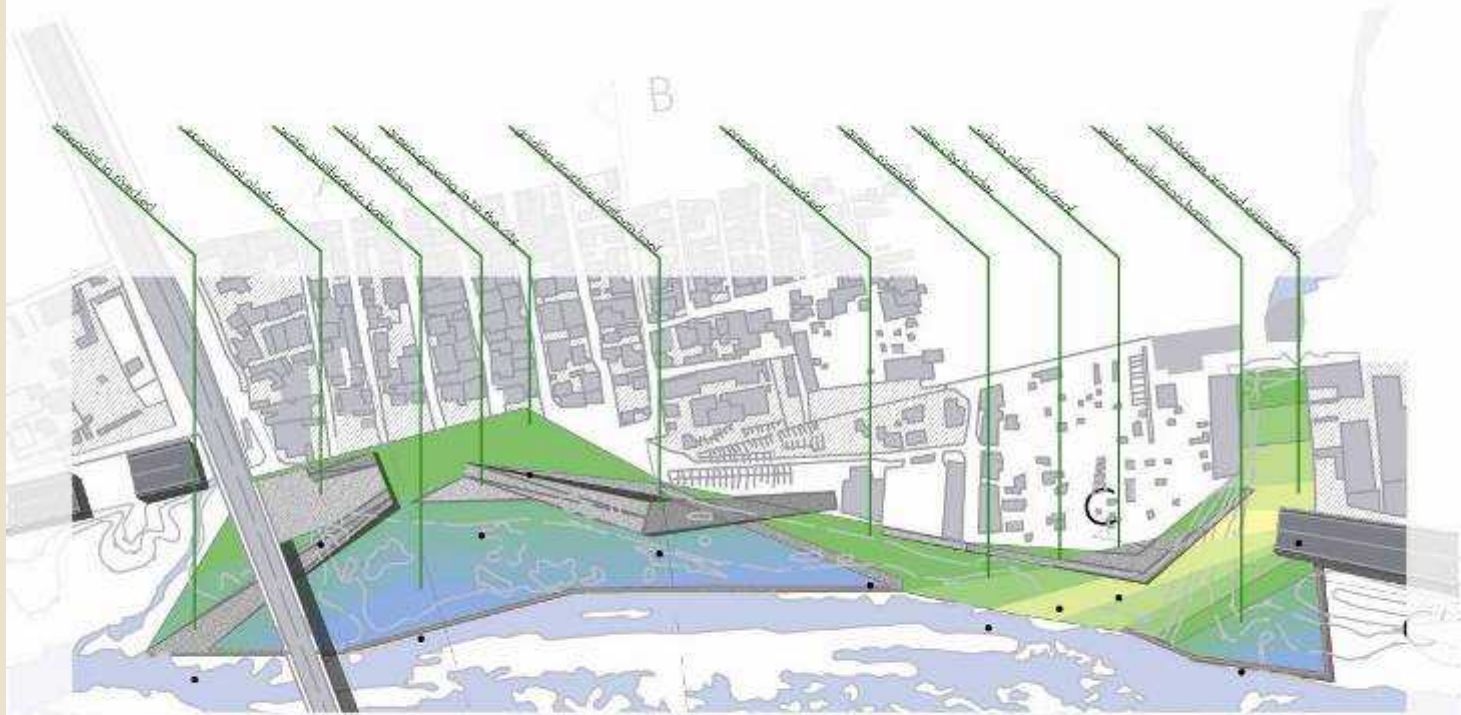

scale 1:1000

map beyond bordering

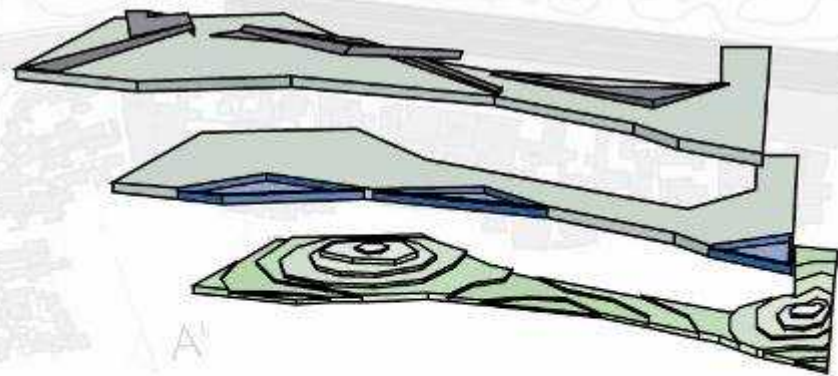

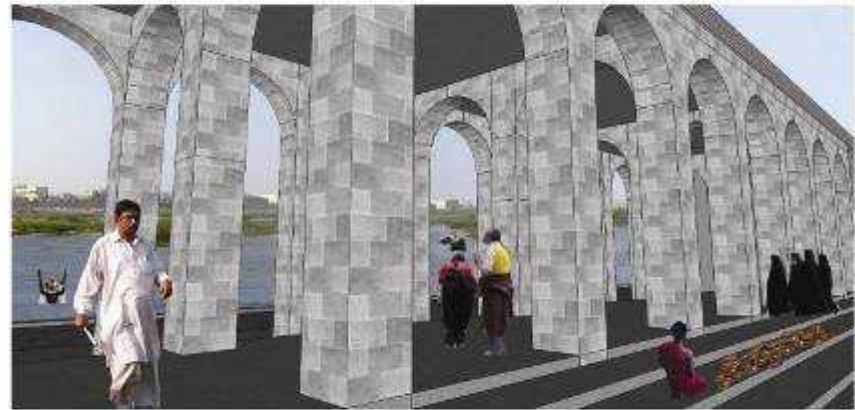

Left; the interior of the dobi ghats.
Right; the animal market on the Void-side.
Below: the graveyard passage

Yaamin
59 years old + Jafar
63 years old

Laila
39 years old + Shadid
43 years old

Amir
37 years old + Farah
35 years old = Samira
17 years old

Nasr
33 years old + Nadys
28 years old

Karim
11 years old

Ali
7 years old

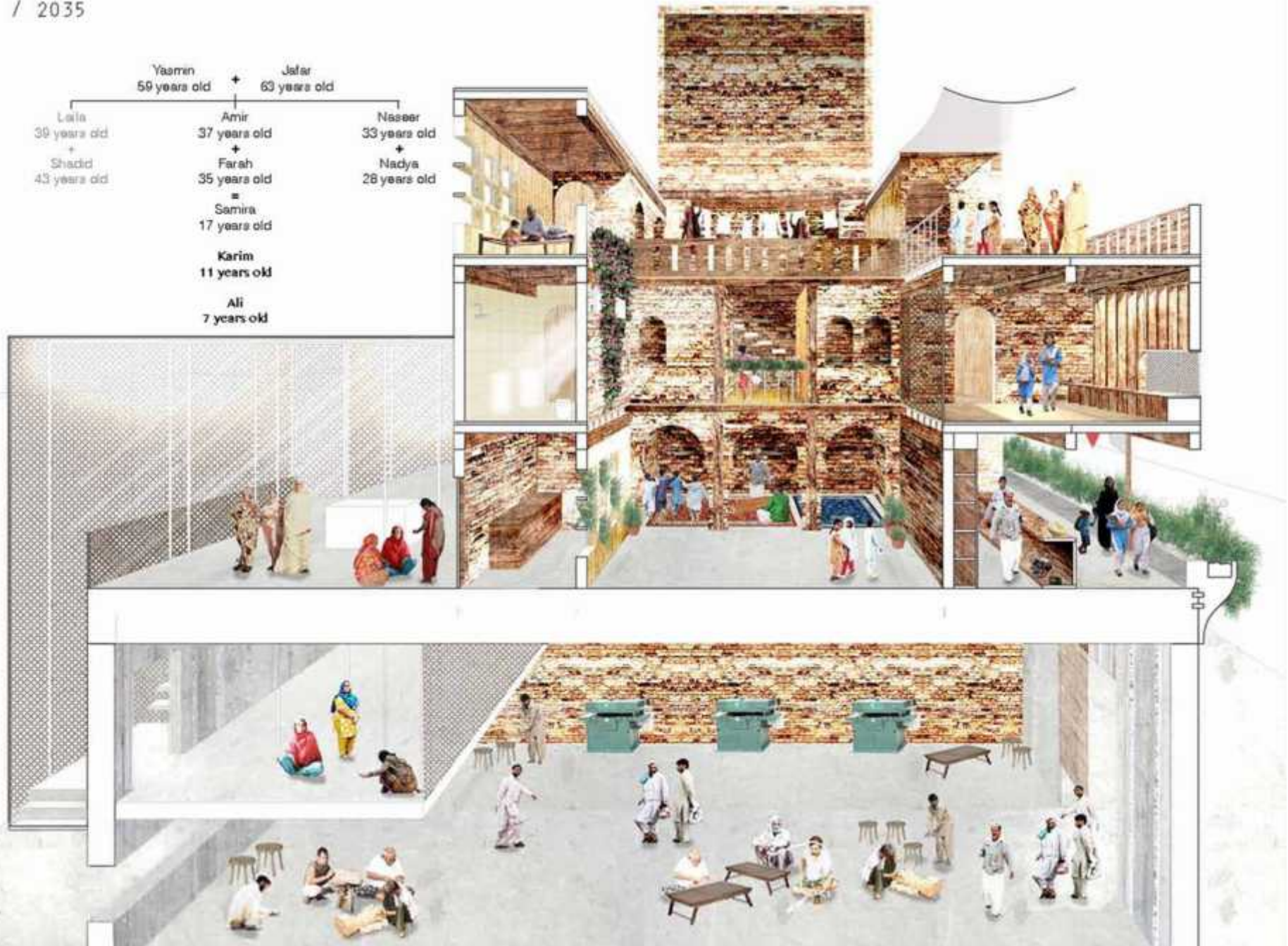



A generous recreation space for the city

Cricket pitches

Solid waste sorting & collection

School playground



Bazaar



Fruit-Food garden







Perspective 02 : Supporting Cultural Consolidation

**Socio - Spatial Research and Design in Creating Intercultural Respect and Social
Sustainability in Contemporary **European** Cities**

RIBA Competition entry: Developing a Multi Level - Mixed Use, Green and Cultural Platform trail addressing the PLACE MAKING of the River Front, Vauxhall Local Centre, Vauxhall Gyrotory and Neighborhood Destinations.

Defining citizenship: rights and political participation

Assessing entrepreneurship and integration into City Making

**CHANGE IN MINDSET ;
VIEWING CULTURAL,
RELIGIOUS AND LINGUISTIC
DIVERSITY IN EUROPE (OR
ELSEWHERE)AS AN ASSET**

Identity, representation, cultural integration and safeguarding specificities

Time and Space , generations and gender in migration and settlement



RIBA Competition entry: Developing a Multi Level - Mixed Use, Green and Cultural Platform trail addressing the PLACE MAKING of the River Front, Vauxhall Local Centre, Vauxhall Gyratory and Neighborhood Destinations.

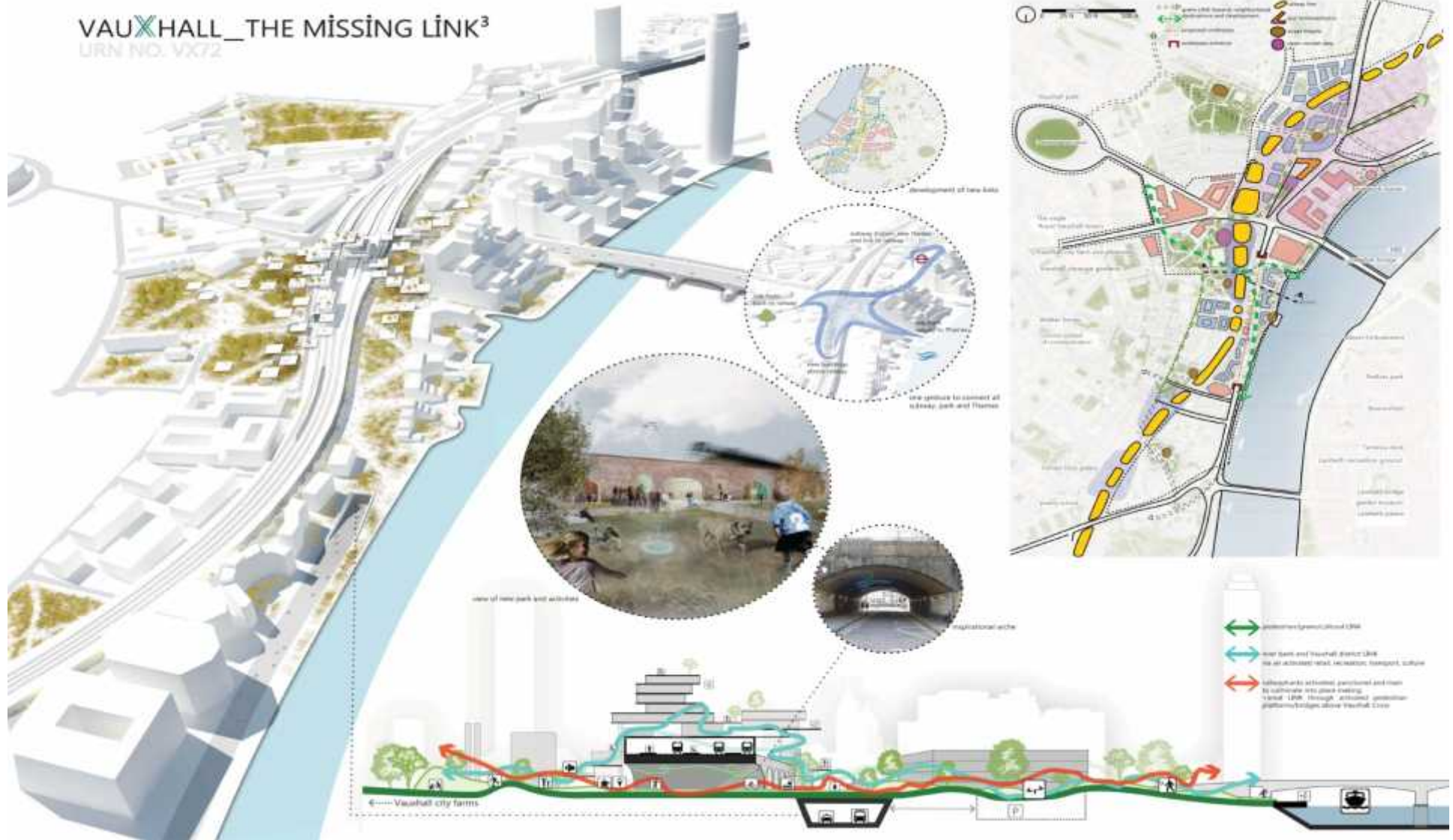



Defining citizenship: rights and political participation

ASSESSING ENTREPRENEURSHIP AND INTEGRATION INTO CITY MAKING

Change in Mindset ; Viewing Cultural, religious and linguistic diversity in Europe (or elsewhere) as an Asset

Identity, representation, cultural integration and safeguarding specificities

Time and Space , generations and gender in migration and settlement

City - Citizens and Space

Spatial strategies integrating social sustainability in the development of Left-Over Spaces



Defining citizenship: rights and political participation

Assessing entrepreneurship and integration into City Making

Change in Mindset ; Viewing Cultural, religious and linguistic diversity in Europe (or elsewhere) as an Asset

Identity, representation, cultural integration and safeguarding specificities

TIME AND SPACE , GENERATIONS AND GENDER IN MIGRATION AND SETTLEMENT

Designing for the IN-BETWEEN space

Aarschotstraat and Brabantstraat - Brussels North

Strategic Design of a Multi-Functional Built and Open Space Typology.

Defining citizenship: rights and political participation

ASSESSING ENTREPRENEURSHIP AND INTEGRATION INTO CITY MAKING

**Change in Mindset ; Viewing
Cultural, religious and linguistic
diversity in Europe (or
elsewhere) as an Asset**

**Identity, representation, cultural
integration and safeguarding
specificities**

**Time and Space , generations and
gender in migration and
settlement**

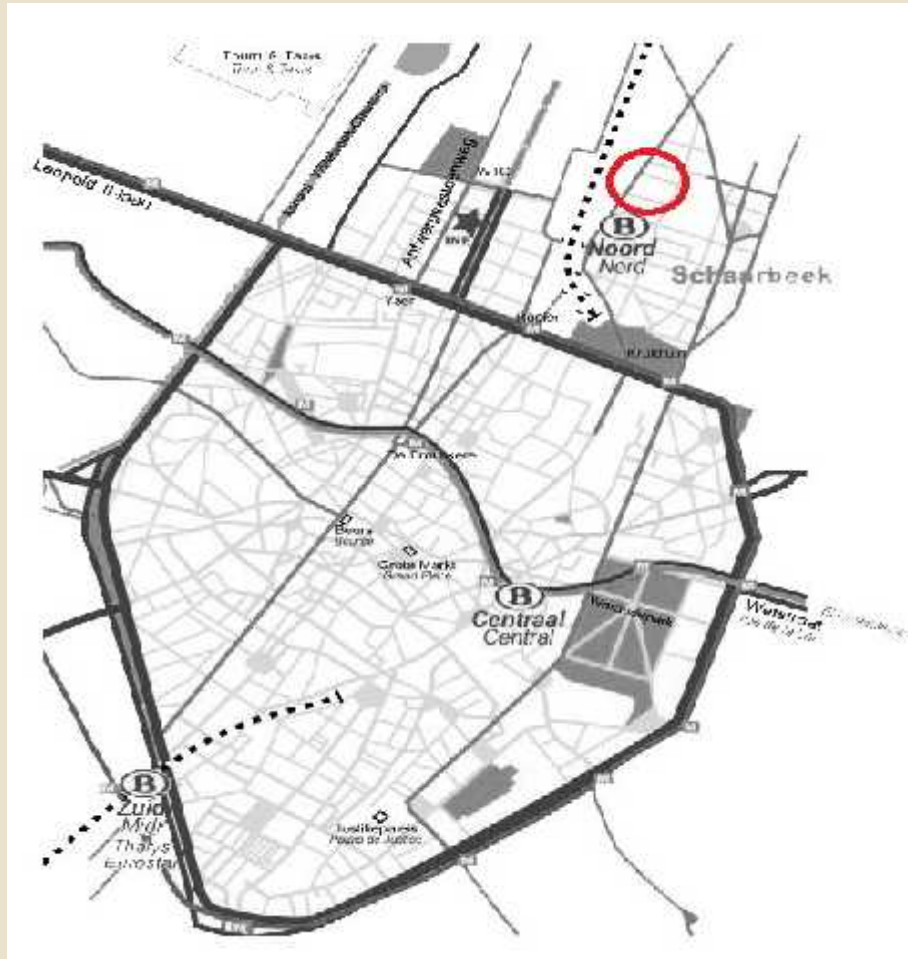

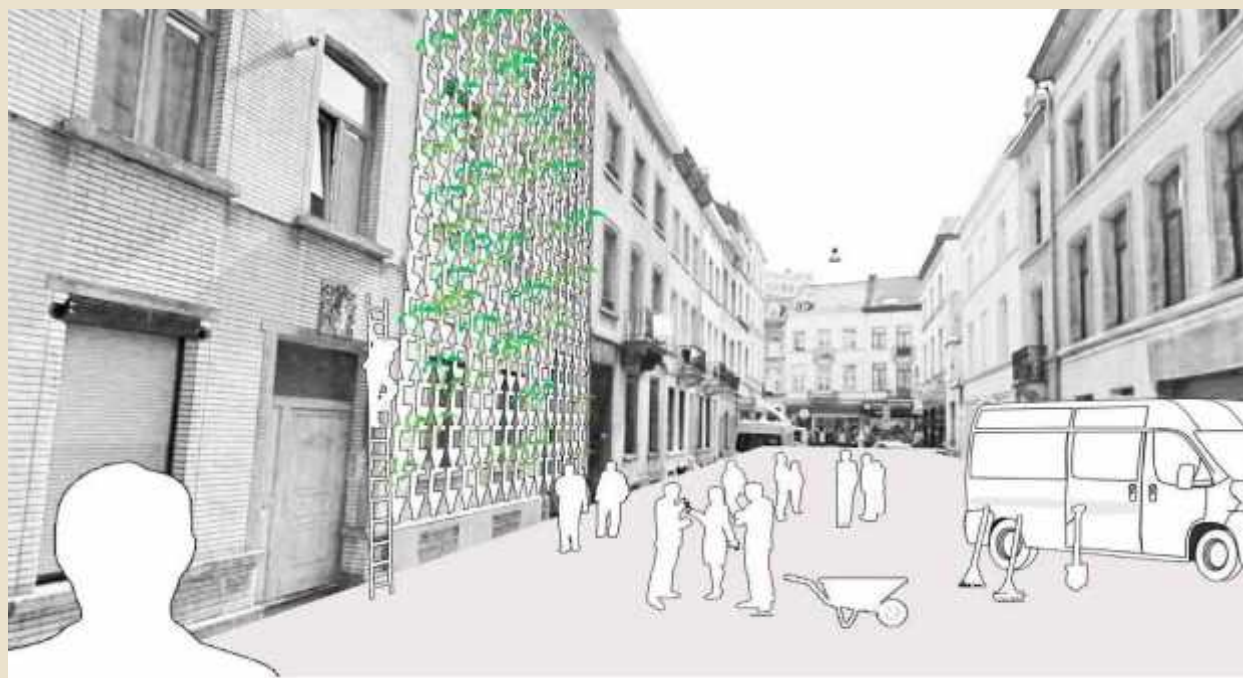
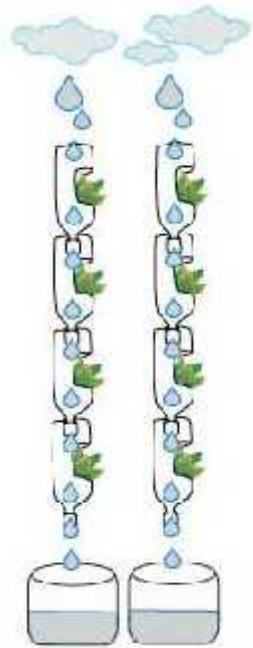







IDENTITY, REPRESENTATION, CULTURAL INTEGRATION AND SAFEGUARDING SPECIFICITIES



Defining citizenship: rights and political participation

Assessing entrepreneurship and integration into City Making

Change in Mindset ; Viewing Cultural, religious and linguistic diversity in Europe (or elsewhere) as an asset

Hoelaart. — Ecole Communale des Garçons
Gemeentelijke Jongenschool



No. 15 HOEVLPERT. — La gare du tram. — L'Eglise. — La maison Communale. — Les Ecoles Communales.
Edific. Epse V. Coossers.



**Historische beelden Mariën- binnengebied en Gemeenteschool
(Bron: Heemkundige kring Hoeilaart)**

2. Probleemstelling op micro-schaal

Bij een meer diepgaande studie van de geselecteerde projectsite kwamen er een aantal **knelpunten** te voorschijn die contra-productief zijn voor de algemene ontwikkeling van de "centrum-as" als een volwaardige samenhangende publieke ruimte.

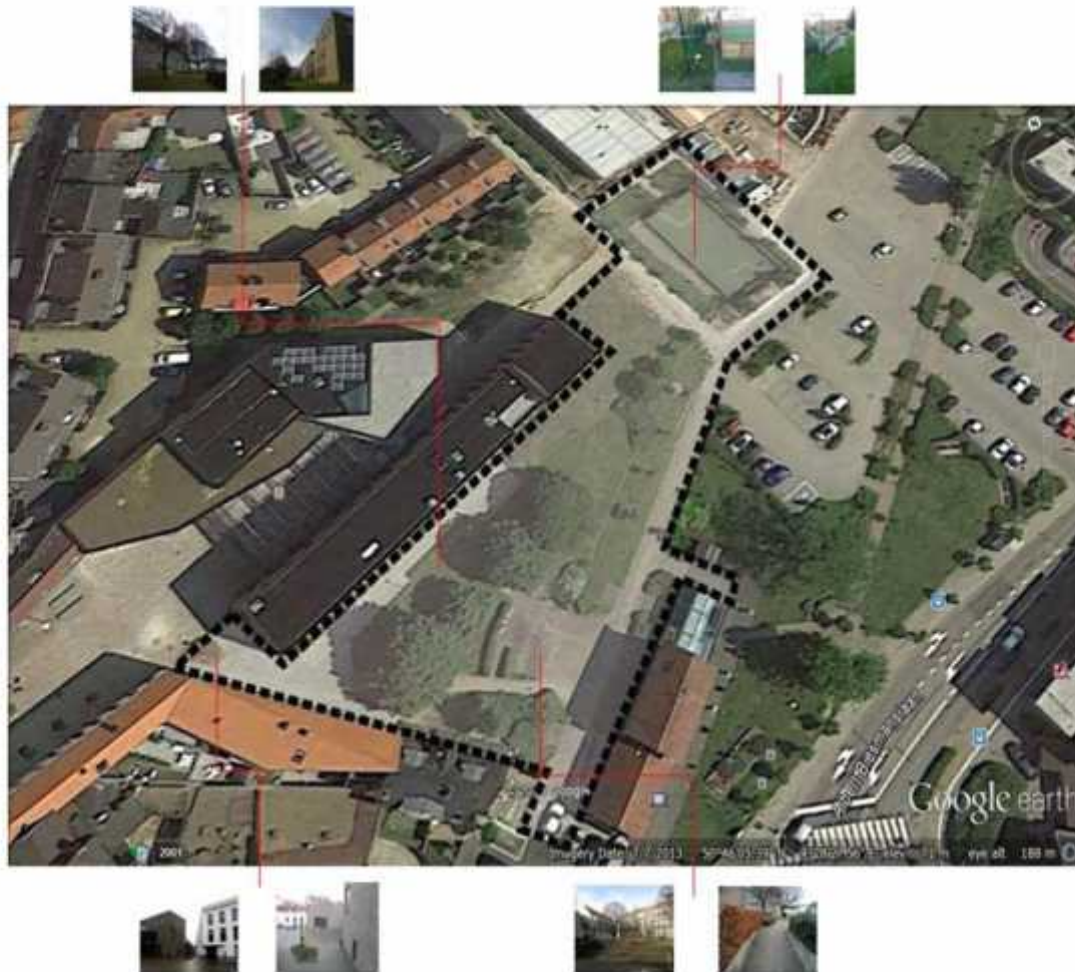

Plan nr.5: De projectsite en zijn knelpunten

a. Gebrek aan aantrekkingskracht - Passieve sfeer / desolaat

De doorgang tussen het politiecommissariaat en het GC Felix Sohie centrum is niet aantrekkelijk genoeg om de mensen die route te laten nemen. Van de 50 ondervraagden zijn er slechts 8 mensen die die route regelmatig nemen om van het centrum naar de Delhaize of Nero cafe te gaan. Het gebied wordt aanzien als de "achterkant" van zowel het Nero cafe als van het GC Felix Sohie. Ondanks het feit dat het Nero café en GC FS centrum zeer actieve centra zijn wordt het park daartussen amper gebruikt en heeft een eerder desolate sfeer.

b. Ondergebruikt amfitheater

Het amfitheater wordt amper gebruikt ondanks het feit dat het goed gedimensioneerd is en publieke voorzieningen heeft zoals zitbanken, rolstoel toegankelijkheid, verlichting en vuilnisbakken.

c. Anti-sociale activiteiten

Ondanks het feit dat het voetbalveld regelmatig wordt gebruikt voor sport heeft het een slechte reputatie gekregen omwille van de anti-sociale activiteiten die daar soms gebeuren in de namiddag en 's avonds.

d. Gebrek aan dialoog

Er is een gebrek aan communicatie tussen Nero Cafe, GC Felix Sohie, politie, jongeren, inwoners etc. die het gebruik van de projectsite negatief beïnvloeden.



















Perspectief nr.3

Duurzame activering van het Mariën- binnengebied

Ref. VZW HOEILAART 2000 - Prijsvraag voor duurzaam project – Hoeilaart

27-10-2014



Eco-educational space in Hoeilaart

Christophe Polak - Asiya Sadiq - Marek Zahra 





ZONE B:

Levensgroot gezelschapspel in het park met integratie van de bestaande keermuur en het groen dak van de schuilplaats geïnspireerd op “Reus, een verhaal over het ontstaan van Hoeilaart” (Auteur: Johan Vanloo)

voorbeelden



Locatie 2 en 2b: Zuidkant van GC Felix Sohie

Omwille van de voetgangersvriendelijke omgeving, zachte ondergrond en aangepaste schaal, lijkt het ons een aangewezen locatie voor een aantal kinderspeeltoigen zoals schommels en carrouzels die potentiële en kinetische energie kunnen produceren. De betegelde oppervlakte, net buiten het GC Felix Sohie, kan voorzien worden van zitbanken zodat deze kunnen gebruikt worden, niet alleen maar door de **CVO studenten**, maar eveneens door **toezijende ouders**. Dit zal gedeeltelijk ook voor **sociale controle** zorgen voor het voetbalveld die op korte afstand ligt. Op regelmatige zomeravonden en tijdens de "Druivenfeesten" kunnen films geprojecteerd worden op de zuidelijke gevel van het GC Felix Sohie.





Professional who can determine the

**Coherent Relationship between;
Sustainable Architectural Design & Practice**

**Design Concepts, Design Process and Design Projects
through a relevant Theoretical Discourse.**

**Sensitization to Context, Realities and Utopia
leading to Ethical and Professional Stance**

**Developing a Design Attitude embedded in a sound
theoretical framework and understanding for making
Sustainable and Contextual Designs**

**Sensing Data ,Idiom and Syntax and
Communication Skills**

**Using a Design Language and Expression which expresses
correct Design Ideas and Vice Versa**

**Analytical skills leading to Reflection and Discourse on;
Sustainable Space Design Visions, Elements and its
Theoretical Joints or Disjoints**

**... To Innovate,
Critique the
Norms, Persist
and Proclaim by
Practice**

.....